

Welcome to Cheltenham Art Gallery & Museum

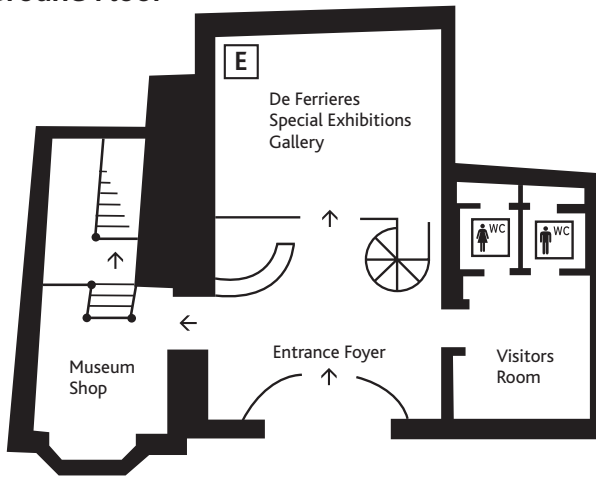

This map will help you find your way around the building. Most of our galleries are on the top floor. There is a lift to all floors - please ask a member of our front-of-house staff if you would like to use it. The café is open until 4.30pm and the building until 5.00pm

Ground Floor



First Floor

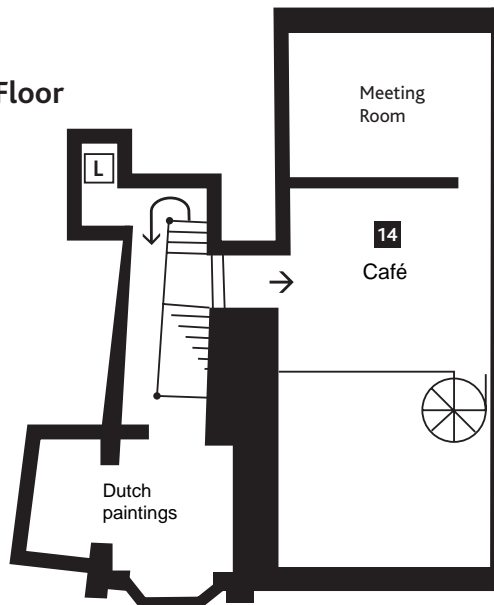

Second Floor

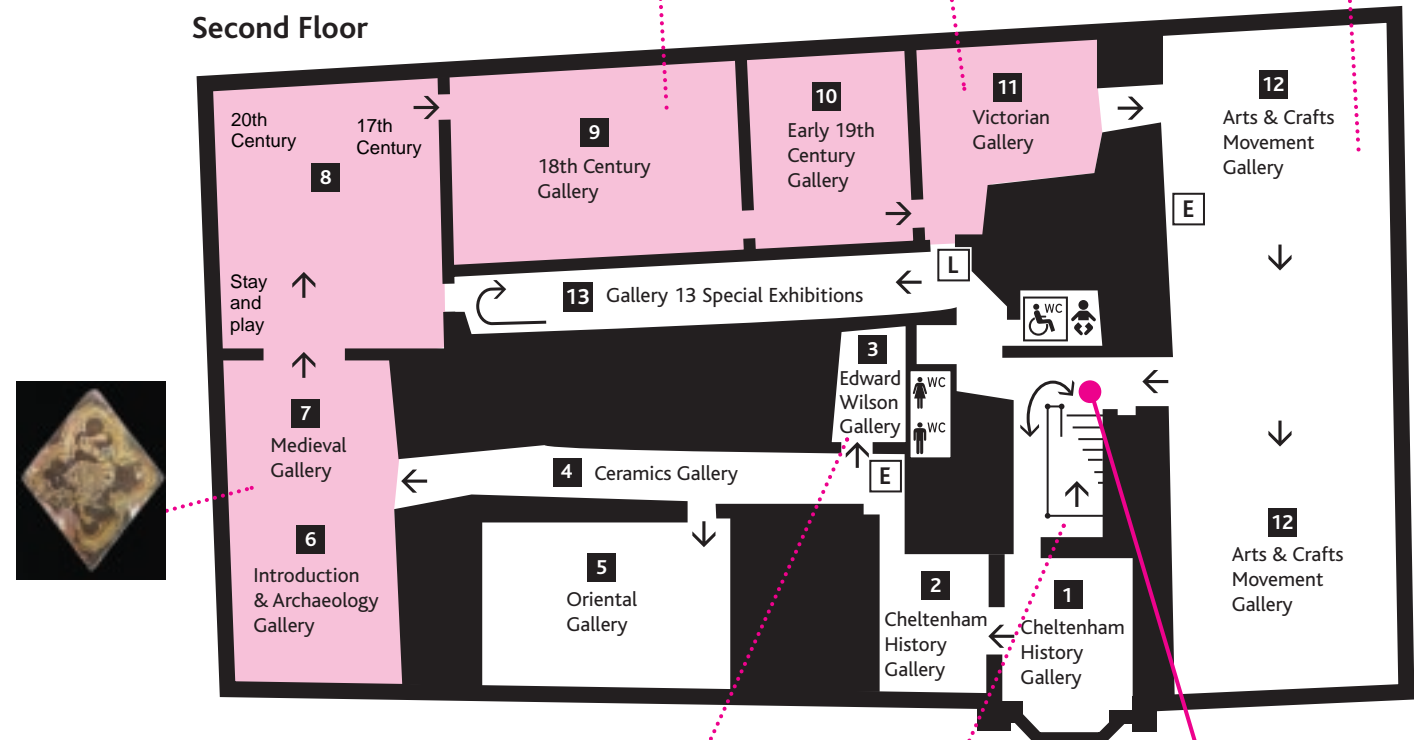

	Mens toilet		Lift access points
	Ladies toilet		Emergency exits
	Disabled persons toilet		Summerfield galleries
	Baby changing room		

At the top of the stairs we recommend you start your tour with the Scotsman which is behind you and move onto the local history gallery.

Please return your map (if not required) for use by another visitor.